



ALMEC Pty Ltd
T/A Landscape Screens
ABN 61 052 505 843

253 Rawson St, Auburn NSW 2144
Ph: 9748 4343 Fax: 9748 4023
E-mail: sales@landscapescreens.com.au

Typical Fixing detail for screens

Fixing directly onto posts:

Flat panels come with pre-cut installation holes and can be bolted directly onto any standard fence or balcony post using wood or metal self-tapping screws.

Tube posts, cut to size and powder coated to match can also be supplied. Posts will need to be concreted a minimum of 400mm into the ground so please allow for that when indicating the length of posts required. Welded baseplates with pre-cut fixing holes can also be added to the posts for fixing where it is not possible to core drill into the concrete.

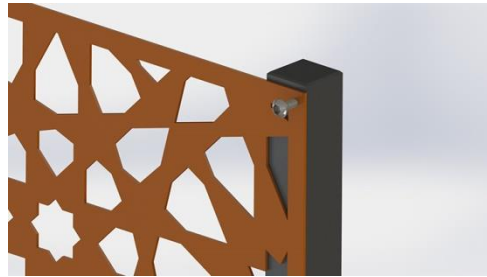

Folded panels can also be fixed between posts or two walls using wood, metal or concrete self-tapping screws.

Bolts with a socket cap pan head are recommended.

Please note: the minimum return on a panel is 20mm with a usual return to match the size of the post.

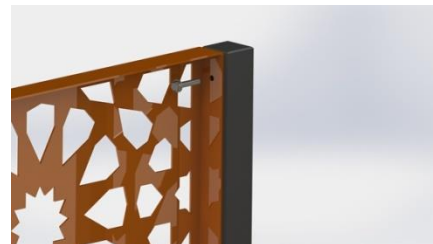

To cover a larger area, folded panels can be bolted together.



Frameless panels utilise the sheet itself to create a fully integrated and cost effective framing system. With double returns on all four sides, the panel is strong enough to work as both a fixed and sliding screen.

Screens can also be supplied in fully welded square hollow section or rectangular hollow section box frames with panels welded recessed into the frame or flat to the front face.

Frames and panels are powder coated to match.

Fixing into top and bottom U channel.

This is the recommended method for mounting panels that are framed or have double folds. It allows for slight imperfections of the structure i.e. surfaces that are not parallel and/or not flat or level.

U-channels are to have internal dimension to accommodate the depth of folded panel; typically 50mm.

U channels are mounted to the top and bottom structure (concrete slab, soffit, timber beam etc.) with appropriate fasteners – masonry anchors, self-tapping screws, etc. The panel gets fitted first into top channel and then pivoted into bottom channel which may have temporary packers fitted at the appropriate height to stop the panel disengaging from top channel.

Once the panel is adjusted to be level and plumb, self-tapping screws are driven into the sides of U channels and panel to permanently fix.

For this method to work, the height of a panel must be that of the opening minus the height of the U channel (50mm typ) minus 15mm.

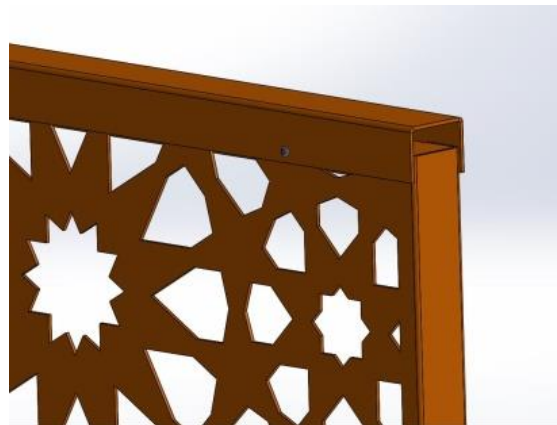
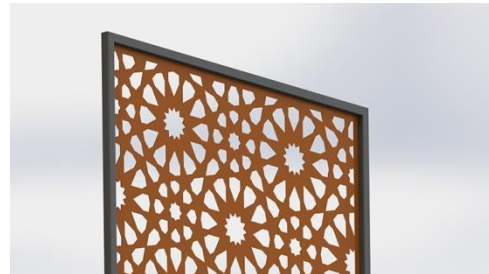
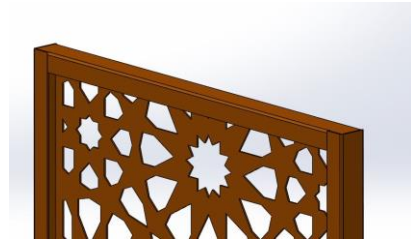

Runners can also be added to either double folded screens or fully framed screens to make movable balcony screens.

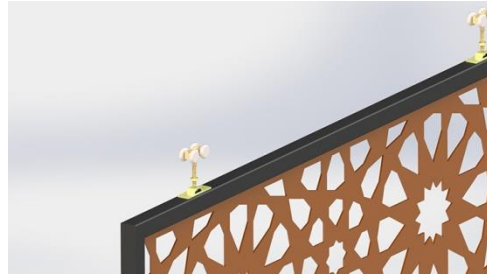

Panels with double returns can also be fixed directly to the wall through pre-cut holes on the front face of the panel or key-hole openings on the back returns.

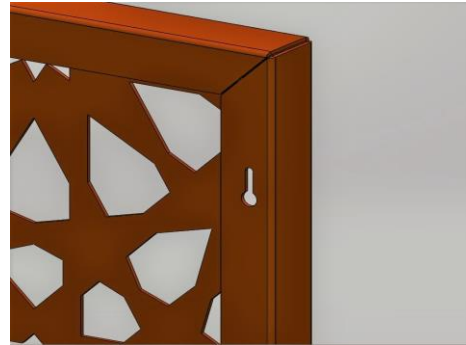

Flat screens can be offset from a wall with aluminium, steel or wood spacers.

Alternatively screens can be fixed with brackets or top hat mounts.



Laser cut roof panels for pergolas can be manufactured in a variety of ways to suit your exact requirements.

Flat panels can be fixed directly over wood or steel beams or folds can be added for extra rigidity.

